

NORTH BOULEVARD COMMUNITY DEVELOPMENT DISTRICT
REVISED
RULES RELATING TO PARKING ENFORCEMENT

In accordance with Chapter 190, Florida Statutes, and on August 17, 2023, at a duly noticed public meeting, the Board of Supervisors of the North Boulevard Community Development District (“District”) adopted the following policy to govern overnight parking and parking enforcement on certain District property (the “Policy”). This Policy repeals and supersedes all prior rules and/or policies governing the same subject matter.

SECTION 1. INTRODUCTION. The District finds that parked Commercial Vehicles, Vehicles, Vessels and Recreational Vehicles (hereinafter defined) on certain of its property (hereinafter defined) cause hazards and danger to the health, safety and welfare of District residents, paid users and the public. This policy is intended to provide the District’s residents and paid users with a means to park Vehicles on-street in certain designated parking areas and remove such Commercial Vehicles, Vehicles, Vessels and Recreational Vehicles from District designated Tow-Away Zones consistent with this Policy and as indicated on Exhibit A attached hereto and incorporated herein by reference.

SECTION 2. DEFINITIONS.

- A.** *Commercial Vehicle.* Any mobile item which normally uses wheels, whether motorized or not, that (i) is titled, registered or leased to a company and not an individual person, or (ii) is used for business purposes even if titled, registered or leased to an individual person.
- B.** *Designated Parking Areas.* Areas which have been explicitly approved for parking by the District, including areas indicated by asphalt markings and areas designated on the map attached hereto as **Exhibit A**.
- C.** *Vehicle(s).* Any mobile item which normally uses wheels, whether motorized or not. For purposes of this Policy, unless otherwise specified, any use of the term Vehicle(s) shall be interpreted so as to include Commercial Vehicle(s), Vessel(s), and Recreational Vessel(s).
- D.** *Vessel(s).* Every description of watercraft, barge, or airboat used or capable of being used as a means of transportation on water.
- E.** *Recreational Vehicle(s).* A vehicle designed for recreational use, which includes motor homes, campers and trailers relative to same.
- F.** *Parked.* A Vehicle, Vessel or Recreational Vehicle left unattended by its owner or user.
- G.** *Tow-Away Zone.* District property in which parking is prohibited and in which the District is authorized to initiate a towing and/or removal action. **Any District property not designated as a designated parking area is a Tow Away Zone.**

SECTION 3. DESIGNATED PARKING AREAS. On street parking is only authorized on the odd numbered side of the street (as indicated by address numbers). On street parking is expressly prohibited on the even numbered side of the street (as indicated by address numbers).

The even numbered side of the street (as indicated by address numbers) and those areas within the District's boundaries depicted in **Exhibit A**, which is incorporated herein by reference, are hereby established as "Tow-Away Zones" for all Vehicles, including Commercial Vehicles, Vessels, Recreational Vehicles as set forth in Sections 4 and 5 herein ("**Tow Away Zone**"). On-street parking is expressly prohibited on District roadways except where indicated. **Any Vehicle parked on District property, including District roads, if any, must do so in compliance with all laws, ordinances, and codes, and shall not block access to driveways and property entrances.**

SECTION 4. ESTABLISHMENT OF TOW-AWAY ZONES. Each area set forth in **Exhibit A** attached hereto is hereby declared a Tow Away Zone. In addition, any Vehicle which is parked in a manner which prevents or inhibits the ability of emergency response vehicles to navigate streets within the District are hereby authorized to be towed.

SECTION 5. EXCEPTIONS.

- A. ON-STREET PARKING EXCEPTIONS.** Abandoned and/or broken down Vehicles are not permitted to be parked on-street at any time and are subject to towing at the owner's expense. Commercial Vehicles, Recreational Vehicles, and Vessels are not permitted to be parked on-street overnight and shall be subject to towing at owner's expense.
- B. VENDORS/CONTRACTORS.** The District Manager or his/her designee may authorize vendors/consultants in writing to park company Vehicles in order to facilitate District business. All Vehicles so authorized must be identified by a written parking pass issued by the District Manager or his/her designee, which must be **clearly** displayed in the Vehicle windshield. **No verbal grants of authority will be issued or be held valid.**
- C. DELIVERY VEHICLES AND GOVERNMENTAL VEHICLES.** Delivery Vehicles, including but not limited to, U.P.S., Fed Ex, moving company Vehicles, and lawn maintenance vendors may park on District property while actively engaged in the operation of such businesses. Vehicles owned and operated by any governmental unit may also park on District property while carrying out official duties.

Any Vehicle parked on District property, including District roads, must do so in compliance with all laws, ordinances and codes.

SECTION 6. TOWING/REMOVAL PROCEDURES.

- A. SIGNAGE AND LANGUAGE REQUIREMENTS.** Notice of the Tow-Away Zones shall be approved by the District's Board of Supervisors and shall be posted on District property in the manner set forth in Section 715.07, *Florida Statutes*. Such signage is to be placed in conspicuous locations, in accordance with Section 715.07, *Florida Statutes*.
- B. TOWING/REMOVAL AUTHORITY.** To effect towing/removal of a Commercial Vehicle, Vehicle, Vessel or Recreational Vehicle, the District Manager or his/her designee must verify that the subject Commercial Vehicle, Vehicle, Vessel or Recreational Vehicle was

not authorized to park under this rule in the Tow-Away Zone, and then must contact a firm authorized by Florida law to tow/remove Commercial Vehicle, Vehicles, Vessels and Recreational Vehicles for the removal of such unauthorized vehicle at the owner's expense. The Commercial Vehicle, Vehicle, Vessel or Recreational Vehicle shall be towed/removed by the firm in accordance with Florida law, specifically the provisions set forth in Section 715.07, *Florida Statutes*. Notwithstanding the foregoing, a towing service retained by the District may tow/remove any vehicle parked in the Tow-Away Zone.

- C. AGREEMENT WITH AUTHORIZED TOWING SERVICE.** The District's Board of Supervisors is hereby authorized to enter into and maintain an agreement with a firm authorized by Florida law to tow/remove unauthorized vehicles and in accordance with Florida law and with the policies set forth herein.

SECTION 7. PARKING AT YOUR OWN RISK. Vehicles, Commercial Vehicles, Vessels or Recreational Vehicles may be parked on District property pursuant to this rule, provided, however, the District assumes no liability for any theft, vandalism and/or damage that might occur to personal property and/or to such Vehicles.

SECTION 8. AMENDMENTS; DESIGNATION OF ADDITIONAL TOW-AWAY ZONES OR DESIGNATED PARKING AREAS. The Board in its sole discretion may amend these Rules Related to Parking Enforcement from time to time to designate new Tow-Away Zones as the District acquires additional common areas. Such designations of new Tow-Away Zones are subject to proper signage and notice prior to enforcement of these rules in such areas.

EXHIBIT A – *Tow Away Zone*

Effective date: August 17, 2023

EXHIBIT A – *Tow Away Zone*

REVISIONS	DATE	NO.

OFFICE: (863) 940-2040
 FAX: (863) 940-2044
 CELL: (863) 662-0018
 DENNIS WOOD, PROFESSIONAL ENGINEER
 LAKELAND, FL 33801
 EMAIL: denniswood@engr.com

Dennis Wood Engineering Inc.
 1925 BARTOW ROAD
 LAKELAND, FL 33801

CDD
NORTH BLVD
CITY OF HAINES CITY
POLK COUNTY, STATE OF FLORIDA

EXHIBIT A
TOW AWAY
ZONE

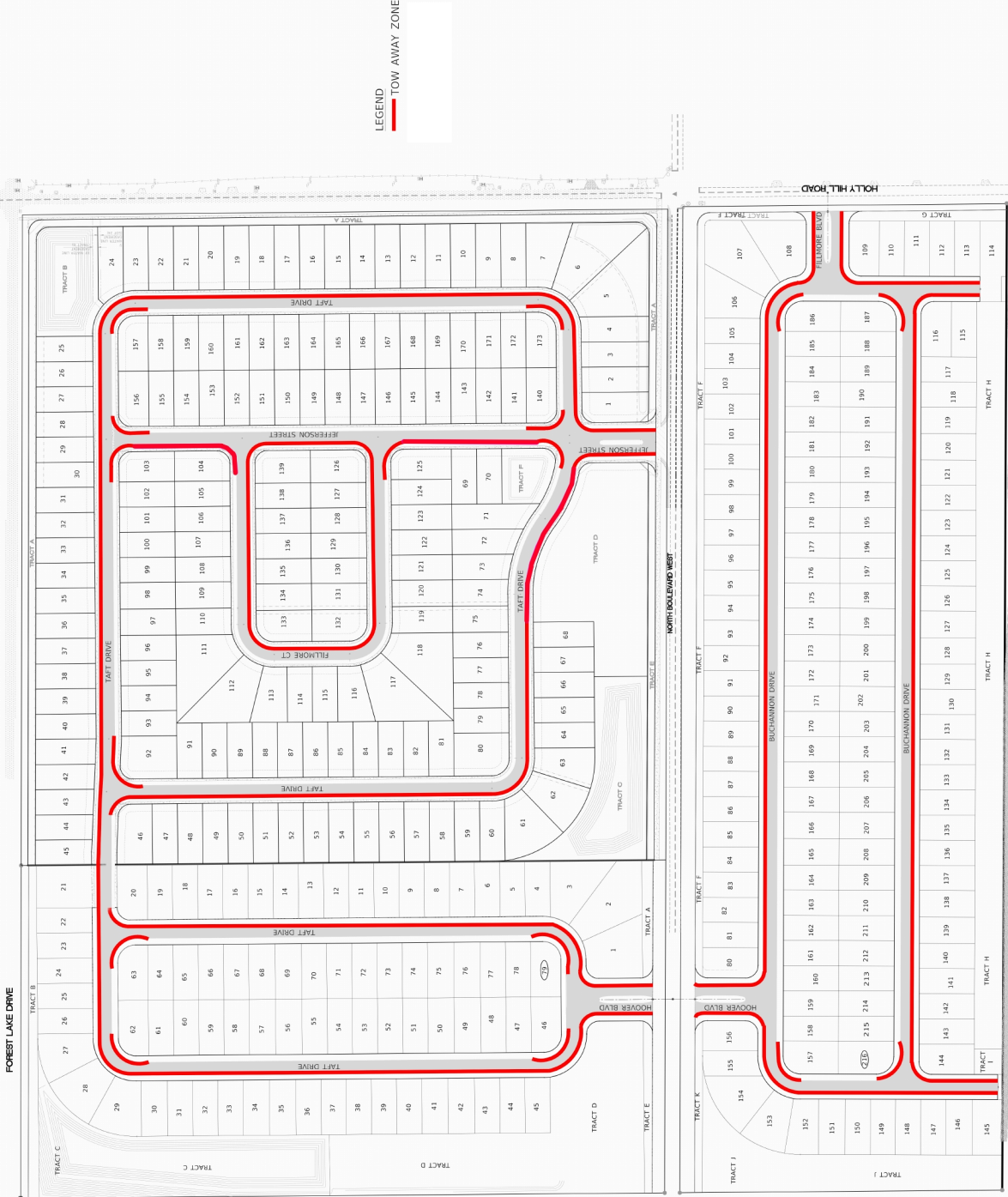

NOT VALID WITHOUT SEAL